



# EZ Run Installation



VGA Applications



Pro Audio/Video Applications



HDMI Applications

2833 West Chestnut Street  
Washington, PA 15301

800-245-4964  
[www.westpenn-wpw.com](http://www.westpenn-wpw.com)

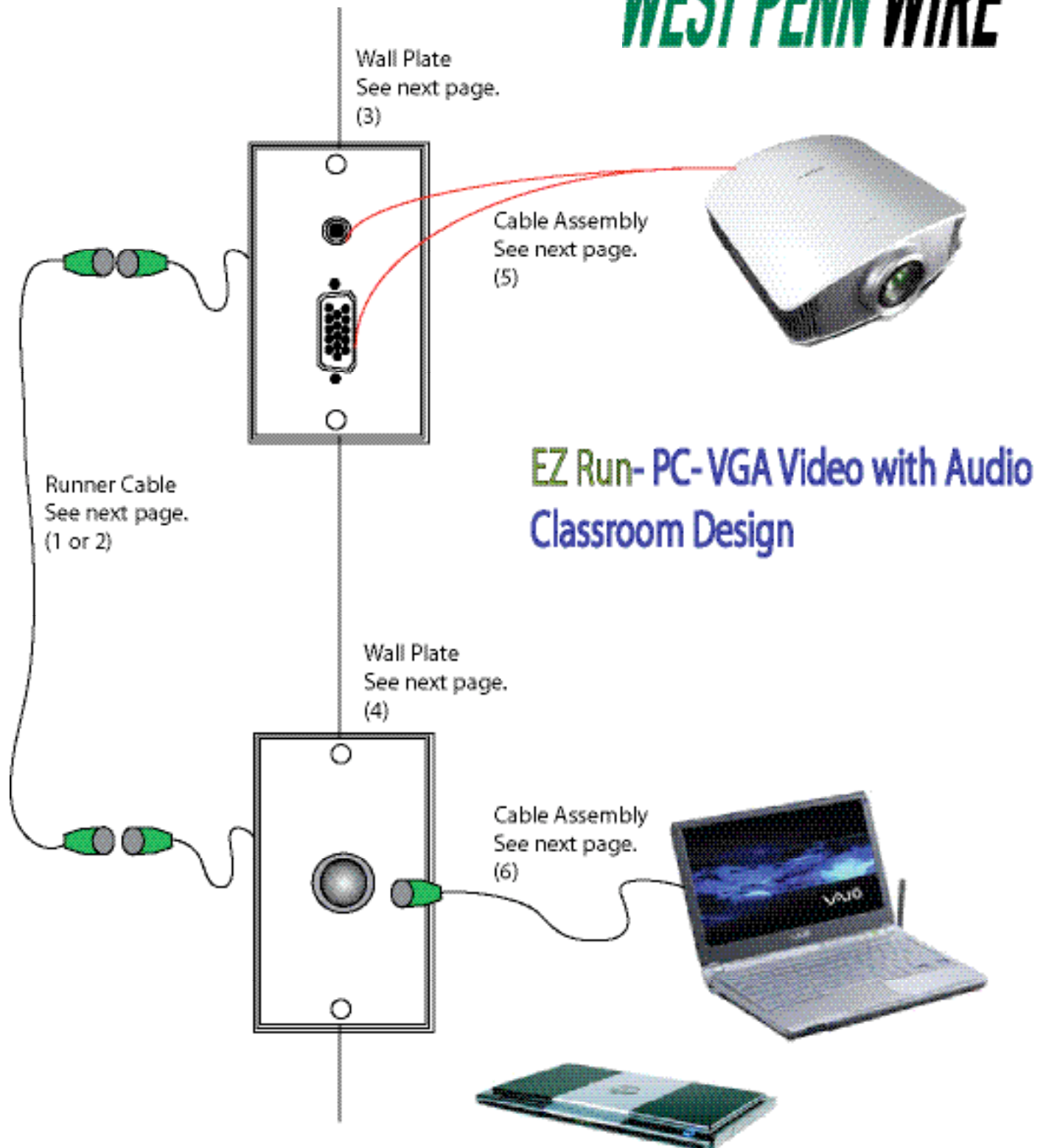



### Runner Cable

Catalog No.	Description	Lengths (ft)
1 <b>CN-EZ01A-xx</b>	UXGA / PC Runner Cable Non-Plenum	Replace xx with: 15, 25, 35, 50, 75, 100, 125, 150
2 <b>CN-EZ02A-xx</b>	UXGA / PC Runner Cable Plenum	Replace xx with: 15, 25, 35, 50, 75, 100, 125, 150

### Wall Plate

Catalog No.	Description
3 <b>CN-EZHD1535-FP</b>	White- HD15 (VGA) + 3.5mm Audio- Din 14 Pigtail
4 <b>CN-EZD14A-FP</b>	White- Din 14 Female- to Din 14 Pigtail



### Cable Assemblies

Catalog No.	Description
5 <b>CN-HDVGAAAP-xx</b>	VGA with 3.5mm Audio - use with CN-EZHD1535-FP 6,10,25 ft.
6 <b>CN-EZHD1535M-xx</b>	Adapter Cable: use with CN-EZD14A-FP 1, 3, 6, 10 ft.



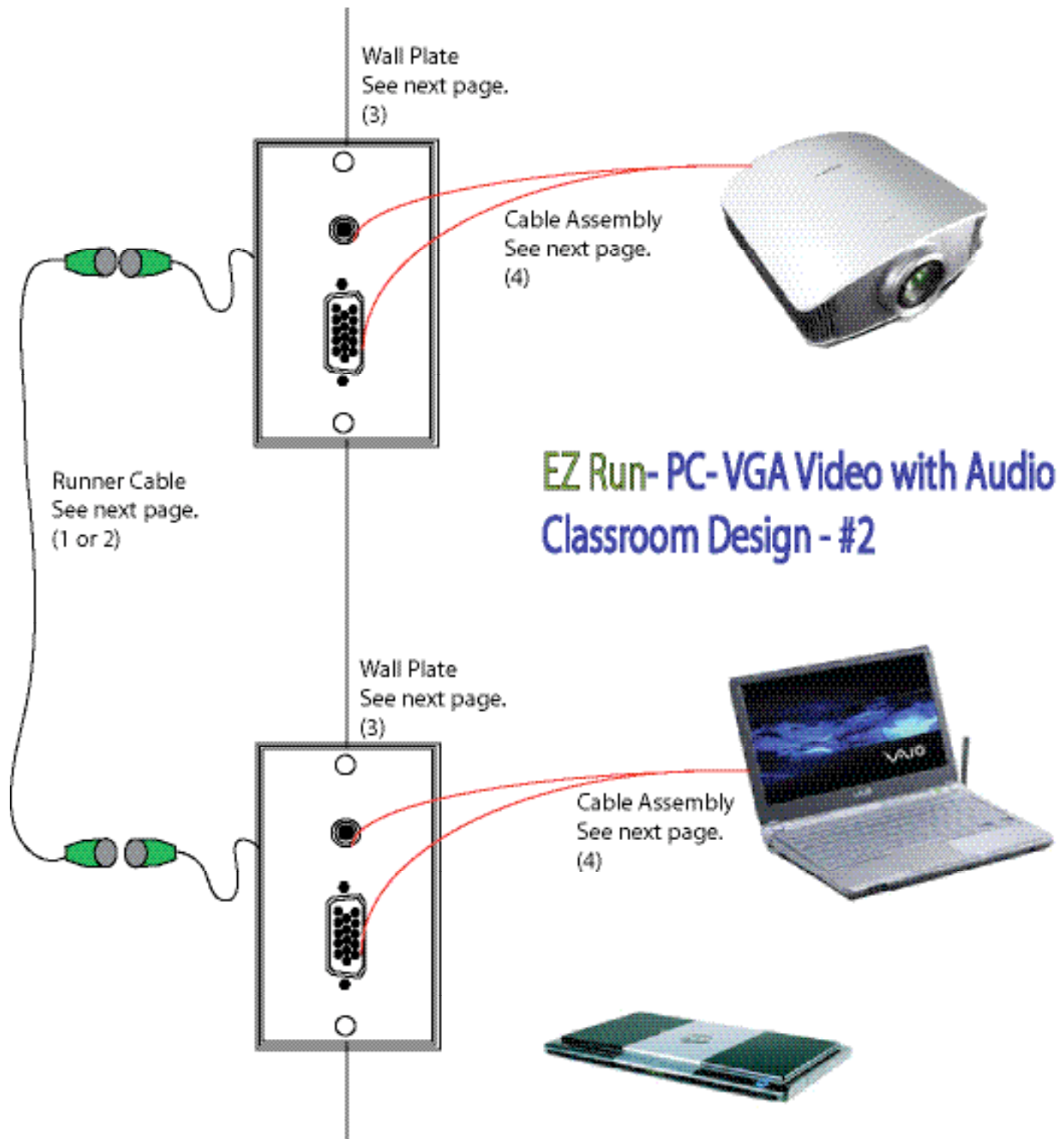



### Runner Cable

Catalog No.	Description	Lengths (ft)
1 <b>CN-EZ01A-xx</b>	UXGA/ PC Runner Cable Non-Plenum	Replace xx with: 15, 25, 35, 50, 75, 100, 125, 150
2 <b>CN-EZ02A-xx</b>	UXGA/ PC Runner Cable Plenum	Replace xx with: 15, 25, 35, 50, 75, 100, 125, 150

### Wall Plate

Catalog No.	Description
3 <b>CN-EZHD1535-FP</b>	White- HD15 (VGA) + 3.5mm Audio- Din 14 Pigtail



### Cable Assemblies

Catalog No.	Description
4 <b>CN-HDVGAAP-xx</b>	VGA with 3.5mm Audio - use with CN-EZHD1535-FP 6,10,25 ft.



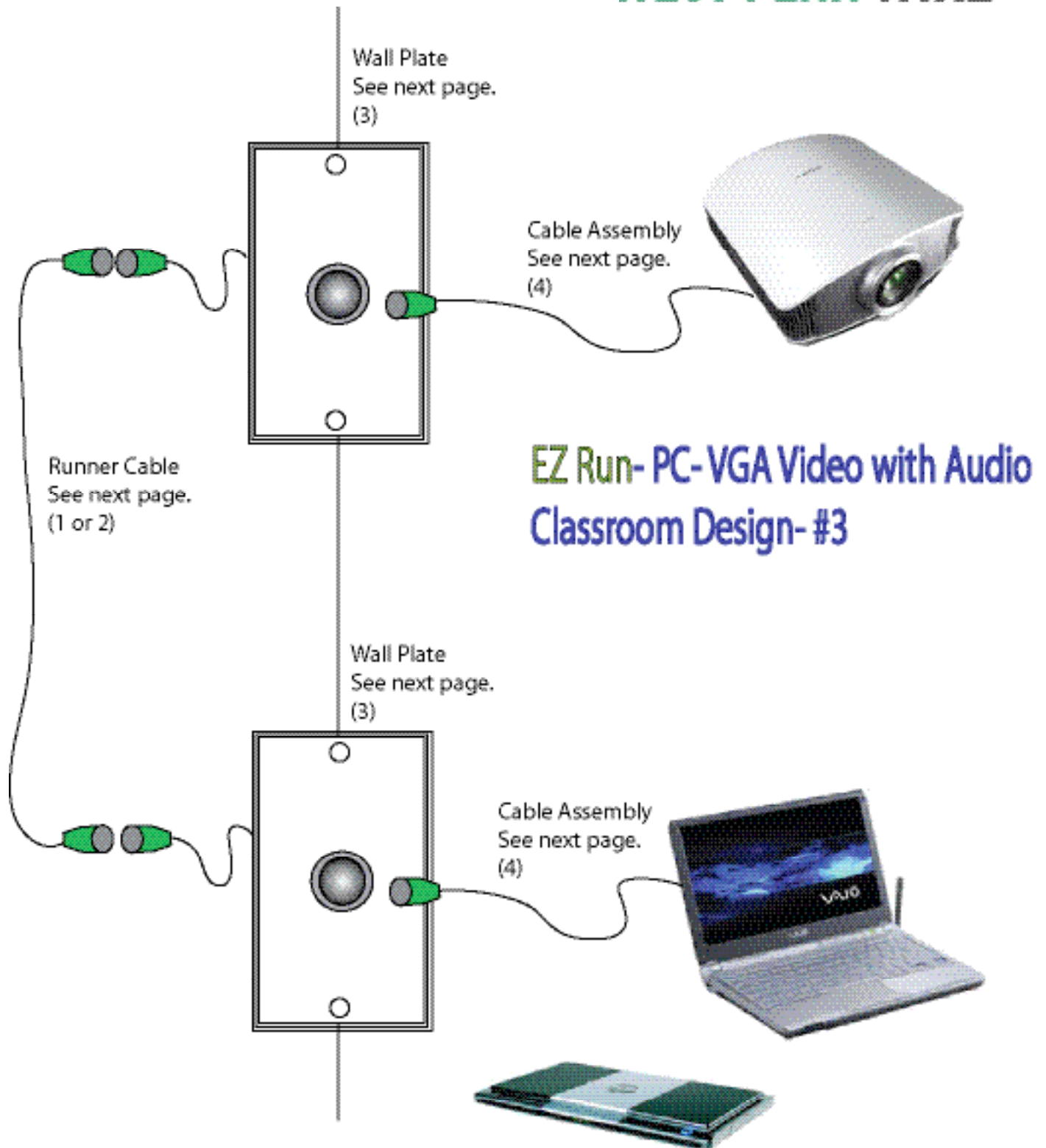

## EZ Run- PC-VGA Video with Audio Classroom Design- #3



### Runner Cable

Catalog No.	Description	Lengths (ft)
1 CN-EZ01A-xx	UXGA/ PC Runner Cable Non-Plenum	Replace xx with: 15, 25, 35, 50, 75, 100, 125, 150
2 CN-EZ02A-xx	UXGA/ PC Runner Cable Plenum	Replace xx with: 15, 25, 35, 50, 75, 100, 125, 150

### Wall Plate

Catalog No.	Description
3 CN-EZD14A-FP	White- Din 14 Female- to Din 14 Pigtail



### Cable Assemblies

Catalog No.	Description
4 CN-EZHD1535M-xx	Adapter Cable: use with CN-EZD14A-FP 1, 3, 6, 10 ft.



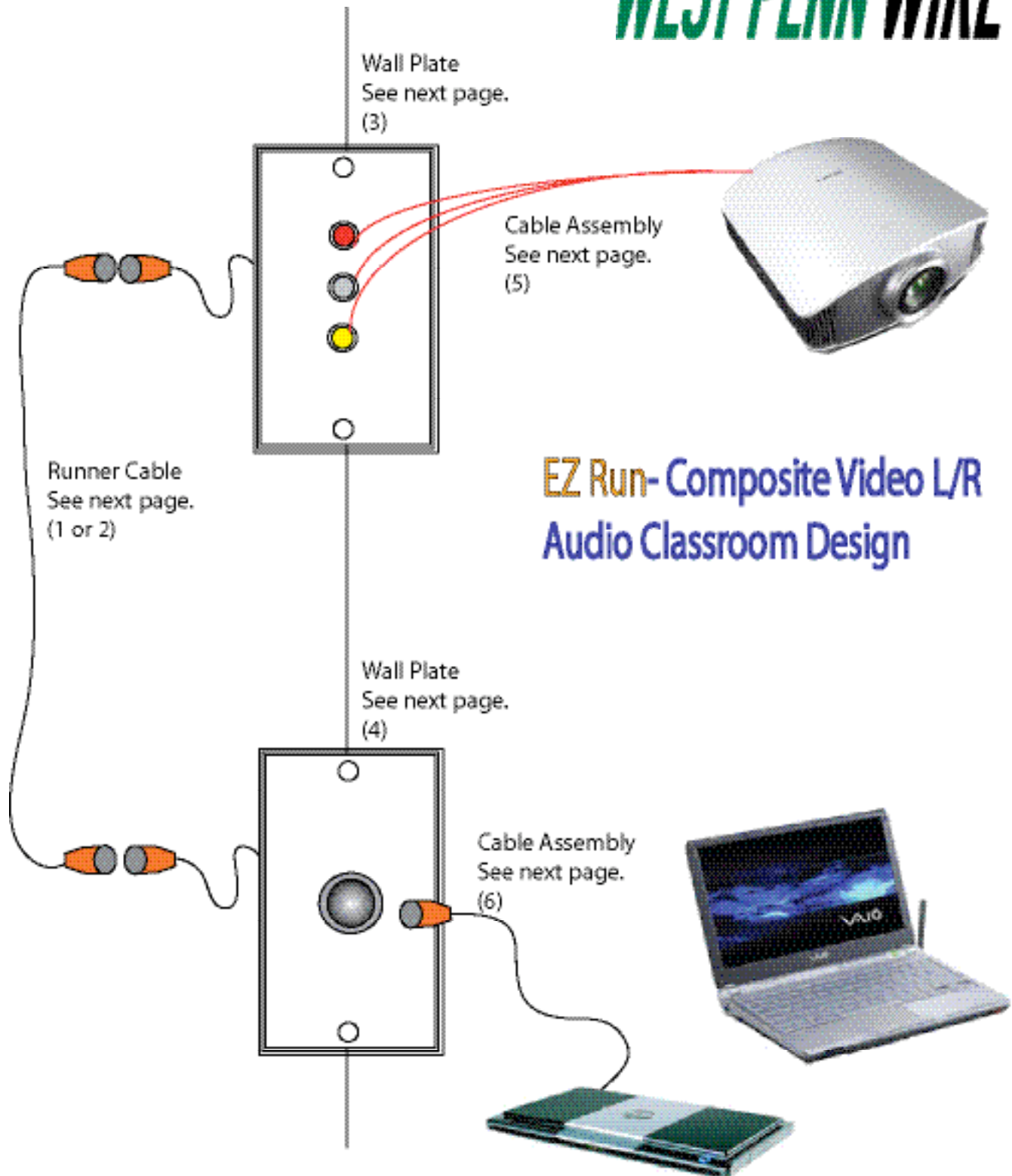



### Runner Cable

Catalog No.	Description	Lengths (ft)
1 <b>CN-EZ01B-xx</b>	AV- Component Video Runner Cable Non-Plenum	Replace xx with: 15, 25, 35, 50, 75, 100, 125, 150
2 <b>CN-EZ02B-xx</b>	AV- Component Video Runner Cable Plenum	Replace xx with: 15, 25, 35, 50, 75, 100, 125, 150

### Wall Plate

Catalog No.	Description
3 <b>CN-EZRWY-FP</b>	White- Composite V- L/R Audio- Din 14 Pigtail
4 <b>CN-EZD14B-FP</b>	White- Din 14 Female- to Din 14 Pigtail



### Cable Assemblies

Catalog No.	Description
5 <b>CN-ERCA-AV-xx</b>	Composite V-L/R Audio use with CN-EZRWY-FP - 3,6,12 ft.
6 <b>CN-EZRWY-xx</b>	Adapter Cable: use with CN-EZD14B-FP 1, 3, 6, 10 ft.



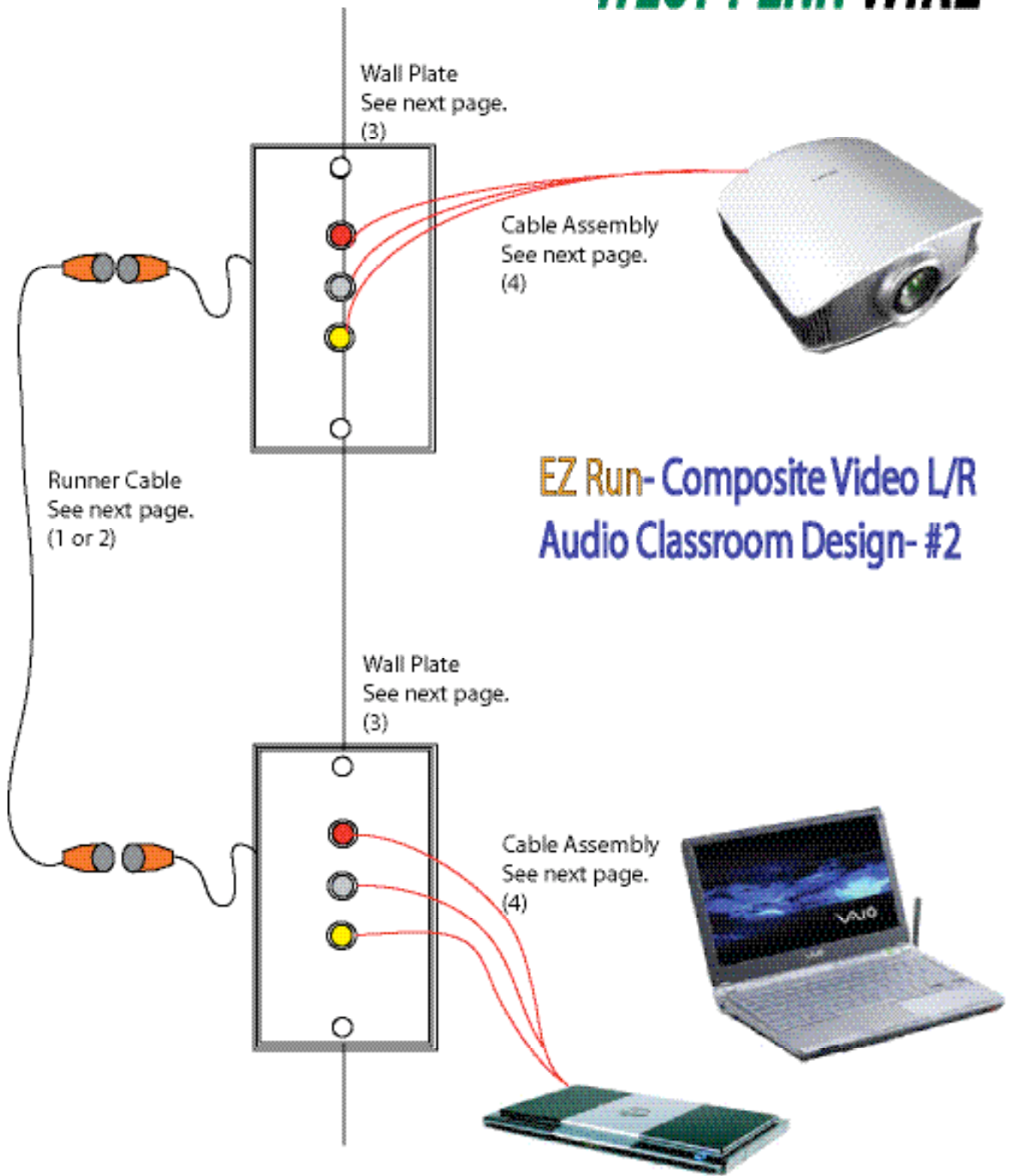

## EZ Run- Composite Video L/R Audio Classroom Design- #2



### Runner Cable

Catalog No.	Description	Lengths (ft)
1 <b>CN-EZ01B-xx</b>	AV- Component Video Runner Cable Non-Plenum	Replace xx with: 15, 25, 35, 50, 75, 100, 125, 150
2 <b>CN-EZ02B-xx</b>	AV- Component Video Runner Cable Plenum	Replace xx with: 15, 25, 35, 50, 75, 100, 125, 150



### Wall Plate

Catalog No.	Description
3 <b>CN-EZRKY-FP</b>	White- Composite V- L/R Audio- Din 14 Pigtail



### Cable Assemblies

Catalog No.	Description
4 <b>CN-ERCA-AV-xx</b>	Composite V-L/R Audio use with CN-EZRKY-FP - 3,6,12 ft.



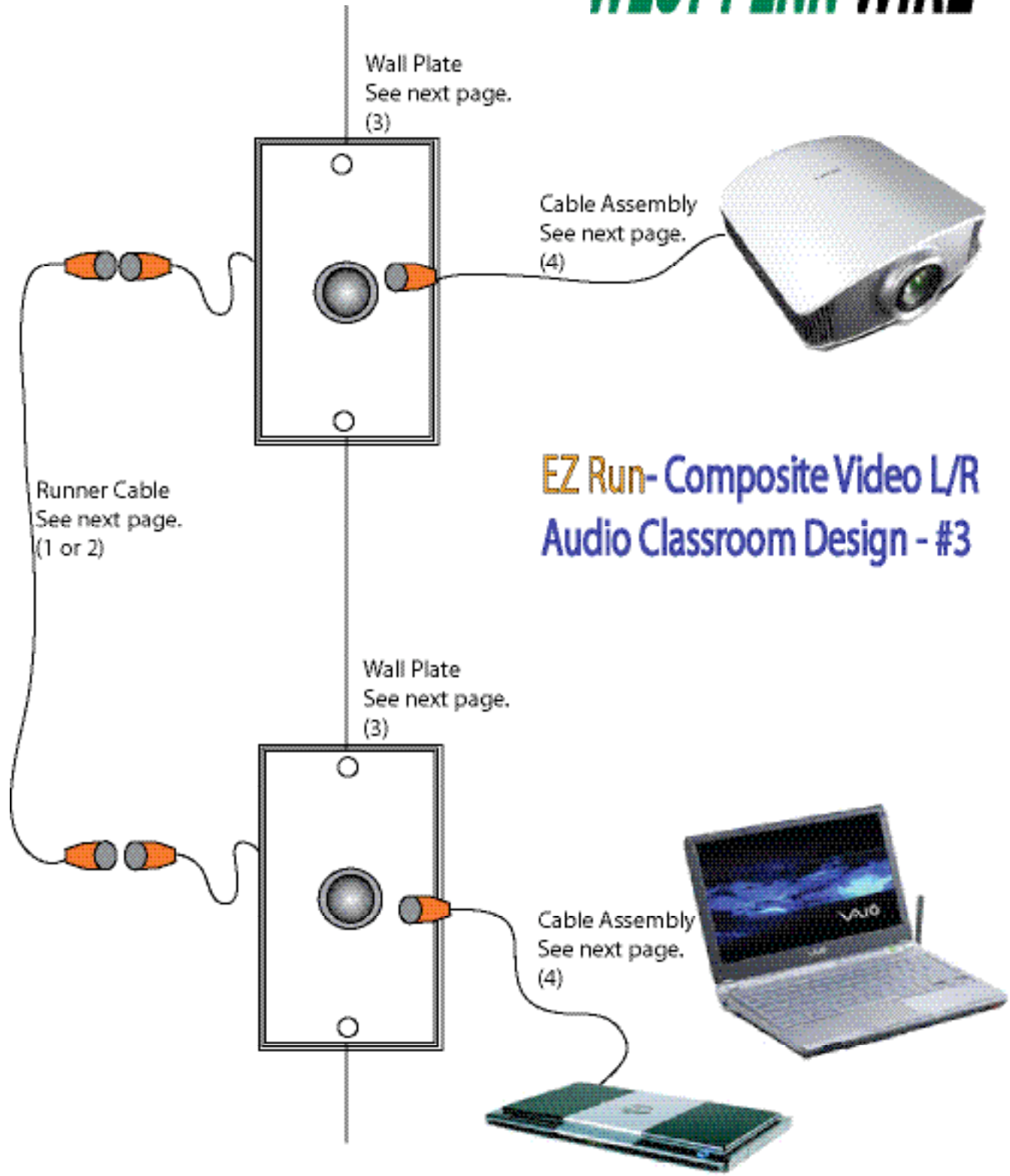



### Runner Cable

Catalog No.	Description	Lengths (ft)
1 <b>CN-EZ01B-xx</b>	AV- Component Video Runner Cable Non-Plenum	Replace xx with: 15, 25, 35, 50, 75, 100, 125, 150
2 <b>CN-EZ02B-xx</b>	AV- Component Video Runner Cable Plenum	Replace xx with: 15, 25, 35, 50, 75, 100, 125, 150

### Wall Plate

Catalog No.	Description
3 <b>CN-EZD14B-FP</b>	White- Din 14 Female- to Din 14 Pigtail



### Cable Assemblies

Catalog No.	Description
4 <b>CN-EZRWY-xx</b>	Adapter Cable: use with CN-EZD14B-FP 1, 3, 6, 10 ft.



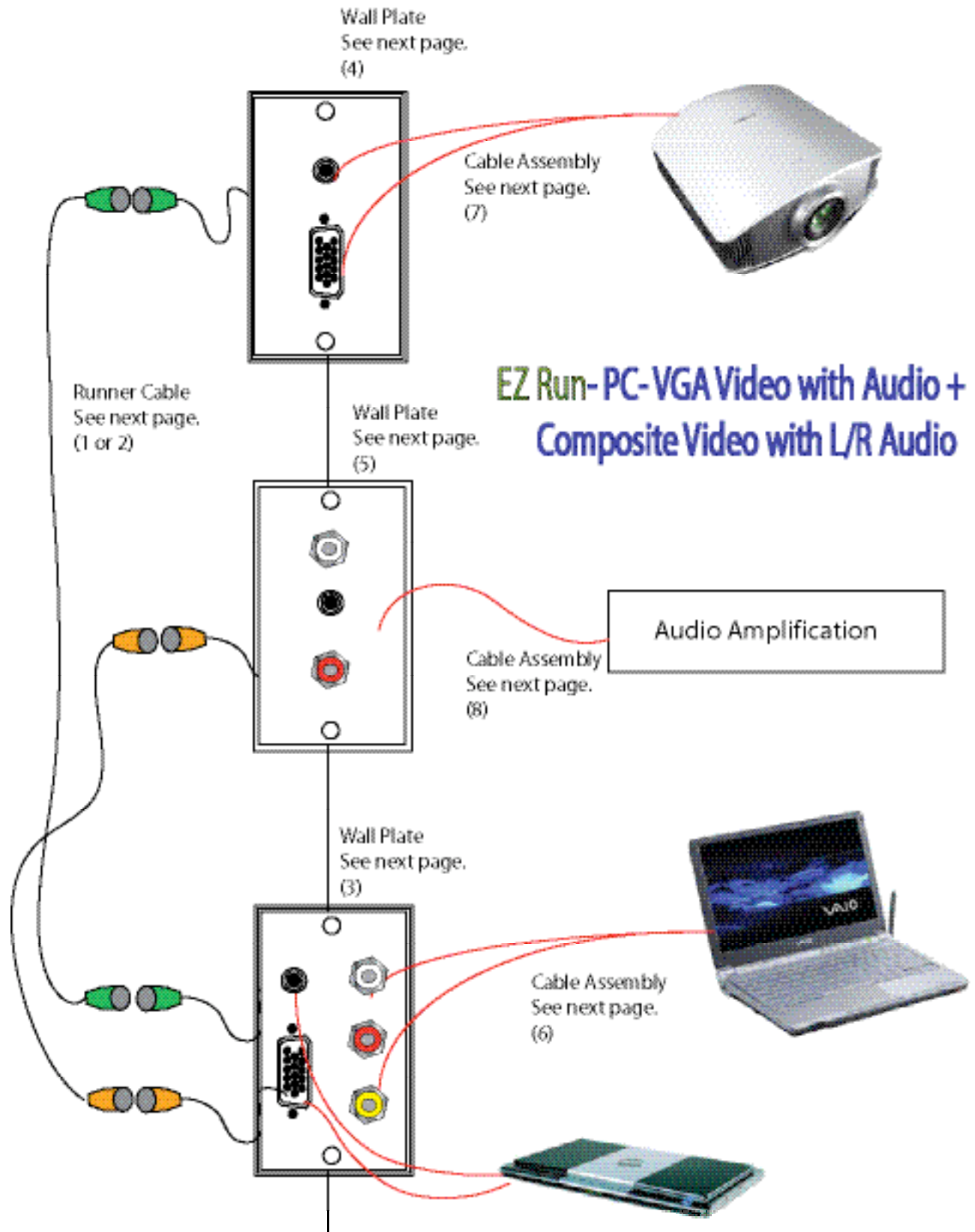



## Runner Cable

Catalog No.	Description	Lengths (ft)
1 <b>CN-EZ01B-xx</b>	AV- Component Video Runner Cable Non-Plenum	Replace xx with: 15, 25, 35, 50, 75, 100, 125, 150
1 <b>CN-EZ02B-xx</b>	AV- Component Video Runner Cable Plenum	Replace xx with: 15, 25, 35, 50, 75, 100, 125, 150
Catalog No.	Description	Lengths (ft)
2 <b>CN-EZ01A-xx</b>	UXGA/ PC Runner Cable Non-Plenum	Replace xx with: 15, 25, 35, 50, 75, 100, 125, 150
2 <b>CN-EZ02A-xx</b>	UXGA/ PC Runner Cable Plenum	Replace xx with: 15, 25, 35, 50, 75, 100, 125, 150

## Wall Plate

Catalog No.	Description
3 <b>CN-VCAP-2-SFP</b>	White- HD15 (VGA) + 3.5mm Audio- 3 RCA- Video- Left/Right Audio
4 <b>CN-VCAPY-SFP</b>	White- HD15 (VGA) + RCA - Video
5 <b>CN-SAWR-SFP</b>	White- 2 RCA (Left/Right Audio) + 3.5mm Audio

## Cable Assemblies

Catalog No.	Description
6 <b>CN-ERCA-AV-xx</b>	Composite Video + L/R Audio 3,6,12 ft
6 <b>CN-HDVGAAP-xx</b>	VGA + 3.5mm Audio 6,10,25 ft
7 <b>CN-VGAMM-xx</b>	VGA (HD15 to HD15) 6,10,25,50 ft
7 <b>CNHD825xxRCA**</b>	RCA to RCA MiniMax Coax 6,10,15,20 ft
8 <b>CN-454SM-xx</b>	3.5mm to 3.5mm 15,25 ft
8 <b>CND25430RA-xx</b>	RCA to RCA Phono 15,25 ft

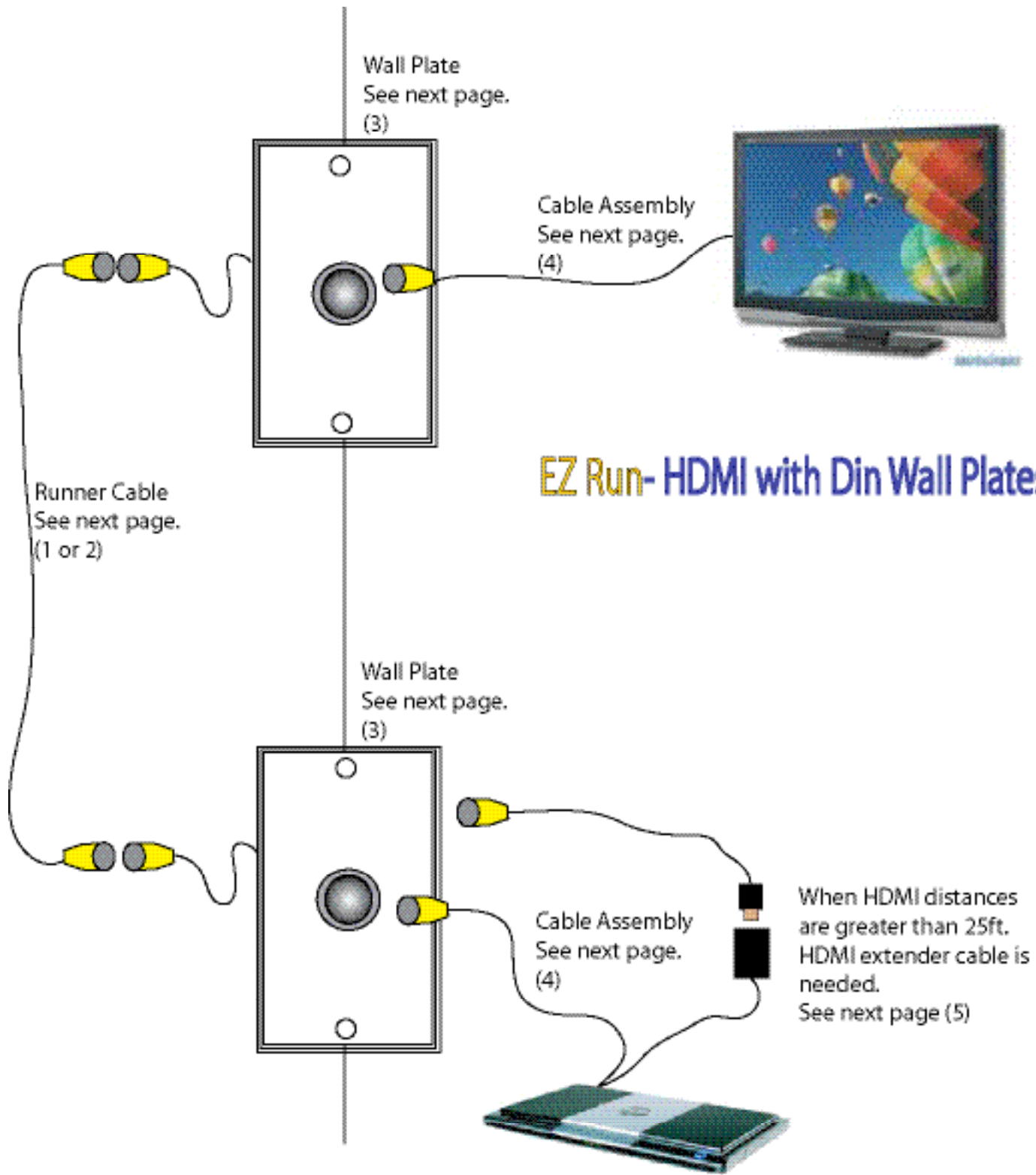

## EZ Run- HDMI with Din Wall Plates



### Runner Cable

Catalog No.	Description	Lengths (ft)
1 <b>CN-EZ01C-xx</b>	HDMI Runner Cable Non-Plenum	Replace xx with: 15, 25, 35, 50, 75, 100, 125, 150
2 <b>CN-EZ02C-xx</b>	HDMI Runner Cable Plenum	Replace xx with: 15, 25, 35, 50, 75, 100, 125, 150

### Wall Plate

Catalog No.	Description
3 <b>CN-EZD19-FP</b>	HDMI- DIN 19 PIN



### Cable Assemblies

Catalog No.	Description
4 <b>CN-EZHDMI-xx</b>	HDMI to Din 19 Pin 1, 3, 6, 10 ft
5 <b>CN-EQL-MF-xx</b>	HDMI EXTENDER CABLE 1 ft - Standard- Custom Lengths upon Request



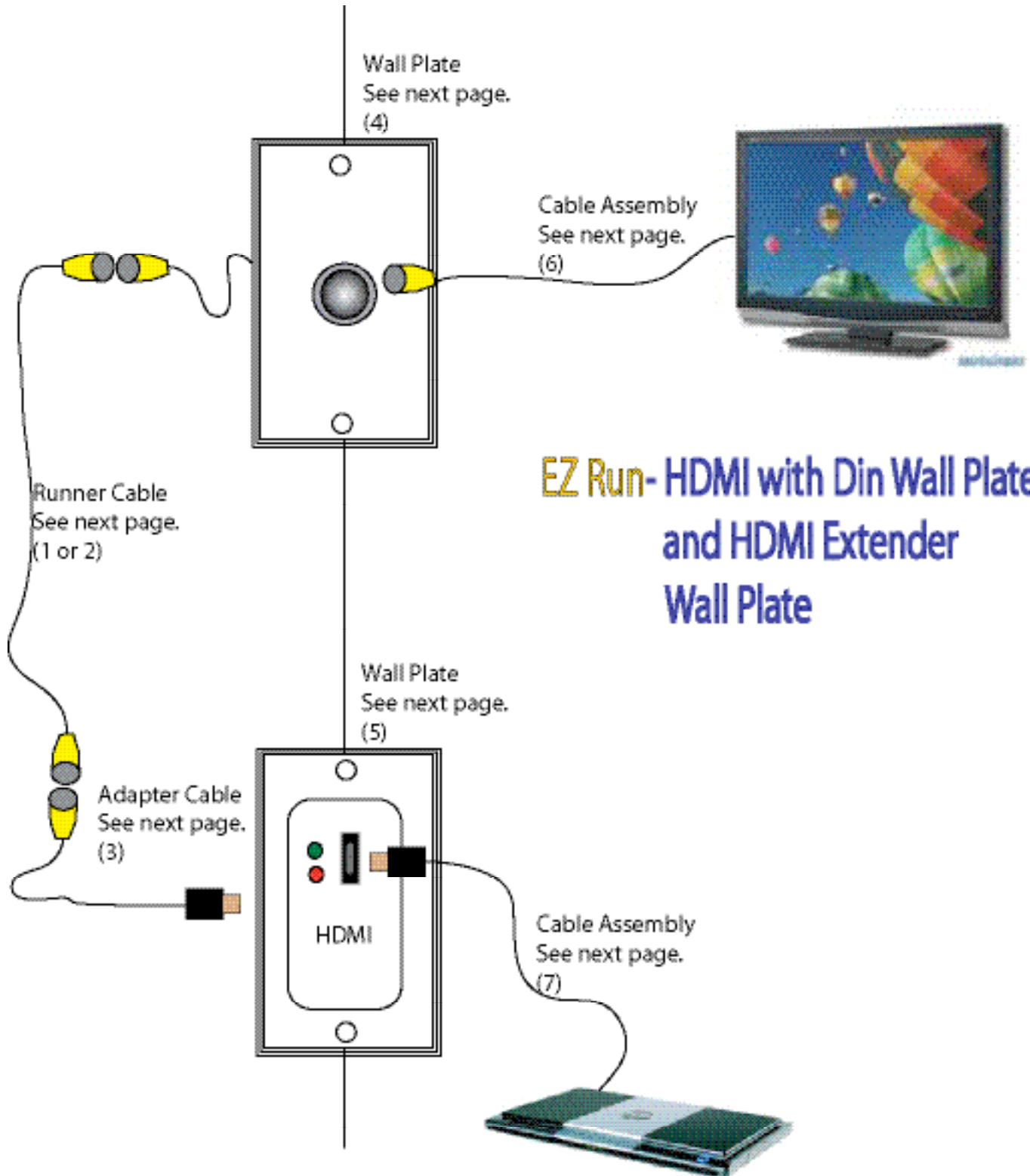

## EZ Run-HDMI with Din Wall Plate and HDMI Extender Wall Plate



### Runner Cable

Catalog No.	Description	Lengths (ft)
1 <b>CN-EZ01C-xx</b>	HDMI Runner Cable Non-Plenum	Replace xx with: 15, 25, 35, 50, 75, 100, 125, 150
2 <b>CN-EZ02C-xx</b>	HDMI Runner Cable Plenum	Replace xx with: 15, 25, 35, 50, 75, 100, 125, 150

### Wall Plate

Catalog No.	Description
4 <b>CN-EZD19-FP</b>	HDMI- DIN 19 PIN
5 <b>CN-EQL-FF-FA-B</b>	HDMI- FACE PLATE WITH EXTENDER BUILT IN



### Cable Assemblies

Catalog No.	Description
3,6 <b>CN-EZHDMI-xx</b>	HDMI to Din 19 Pin Assembly 1, 3, 6, 10 ft
7 <b>CN-HDMIUL-xxm</b>	HDMI to HDMI Assembly 2,3,6,8,10,12,15,20 meters



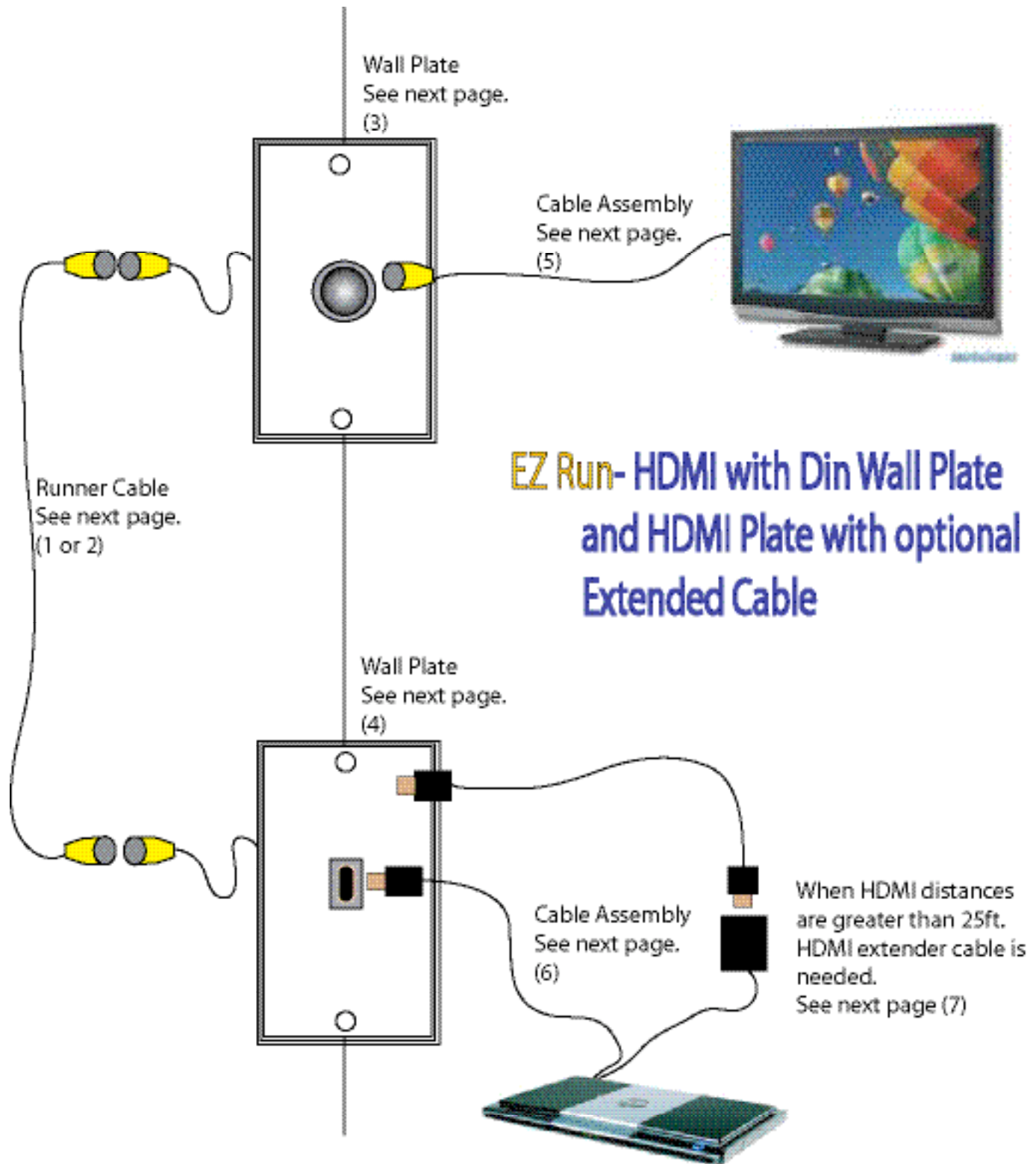



### Runner Cable

Catalog No.	Description	Lengths (ft)
1 <b>CN-EZ01C-xx</b>	HDMI Runner Cable Non-Plenum	Replace xx with: 15, 25, 35, 50, 75, 100, 125, 150
2 <b>CN-EZ02C-xx</b>	HDMI Runner Cable Plenum	Replace xx with: 15, 25, 35, 50, 75, 100, 125, 150

### Wall Plate

Catalog No.	Description
3 <b>CN-EZD19-FP</b>	HDMI- DIN 19 PIN
4 <b>CN-EZHDMI-FP</b>	HDMI- FACE PLATE



### Cable Assemblies

Catalog No.	Description
5 <b>CN-EZHDMI-xx</b>	HDMI to Din 19 Pin Assembly 1, 3, 6, 10 ft
6 <b>CN-HDMIUL-xxm</b>	HDMI to HDMI Assembly 2,3,6,8,10,12,15,20 meters
7 <b>CN-EQL-MF-xx</b>	HDMI EXTENDER CABLE 1 ft - Standard- Custom Lengths upon Request



# **WEST PENN WIRE**

2833 West Chestnut Street  
Washington, PA 15301

Toll Free: 800-245-4964  
Fax: 724-222-6420  
[www.westpenn-wpw.com](http://www.westpenn-wpw.com)

**Our Classroom brochure is designed for a majority of K-12 Audio Video design. West Penn Wire provides other solutions for K-12 Audio Video designs. Contact your local Manufacturers Representative or contact West Penn Wire direct.**